

iMAP - Property Information (Planning)

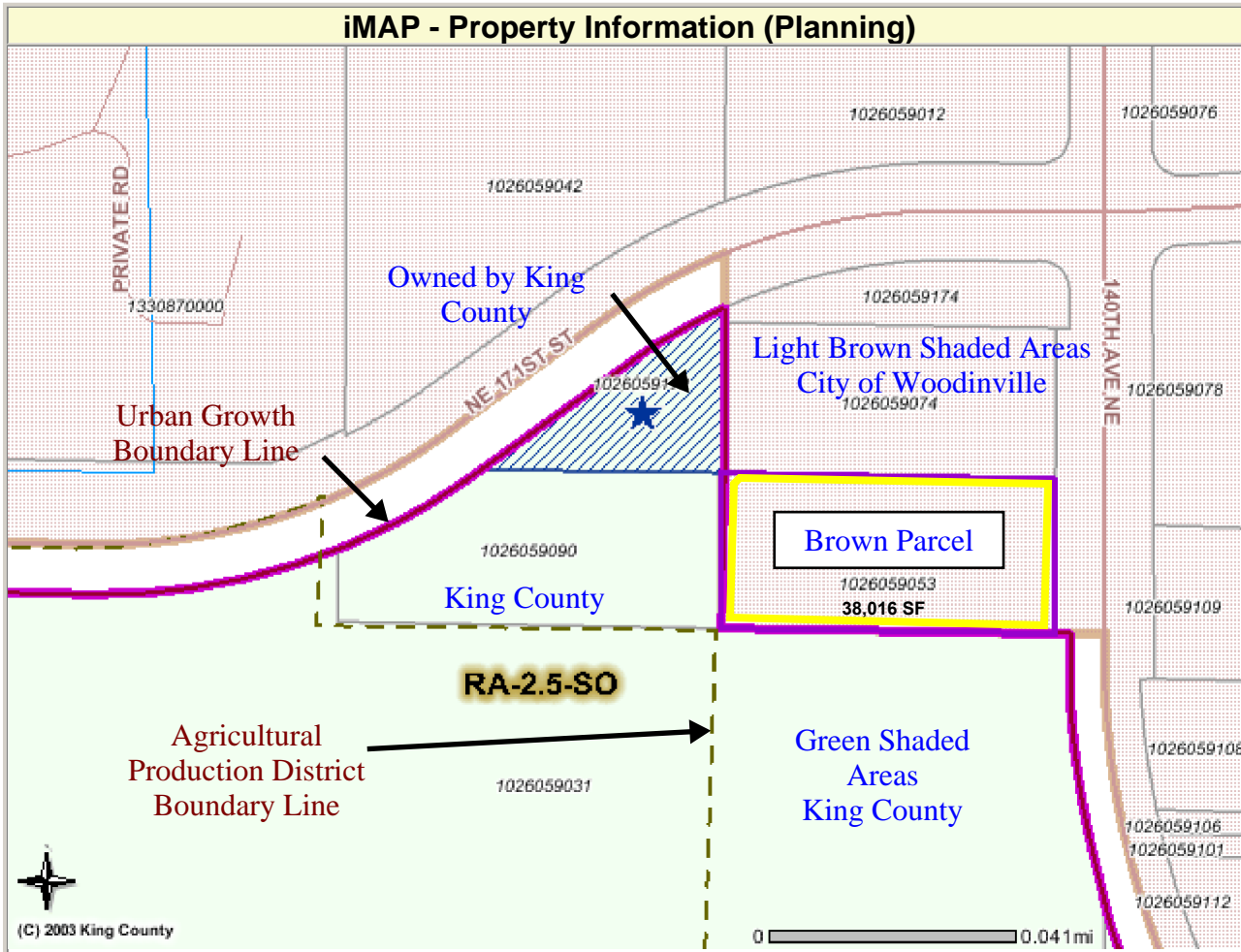

(C) 2003 King County

0 0.041mi

Legend			
	Selected Parcels		
	County Boundary		
	Streets		
	Highway		
	Arterials		
	Local		
	Forest Production District Boundary		
	Agricultural Production District Boundary		
	Urban Growth Area Line		
	Lakes and Large Rivers		
	Streams		
	Muckleshoot Tribe		
	King County owned properties		
	Parcels		
Zoning Labels			
Zoning			
	A-10 - Agricultural, one DU per 10 acres		R-24 - Residential, 24 DU per acre
	A-35 - Agricultural, one DU per 35 acres		R-48 - Residential, 48 DU per acre
	F - Forest		NB - Neighborhood Business
	M - Mineral		CB - Community Business
	RA-2.5 - Rural Area, one DU per 5 acres		RB - Regional Business
	RA-5 - Rural Area, one DU per 5 acres		O - Office
	RA-10 - Rural Area, one DU per 10 acres		I - Industrial
	UR - Urban Reserve, one DU per 5 acres		Other
	R-1 - Residential, one DU per acre		Incorporated Area
	R-4 - Residential, 4 DU per acre		
	R-6 - Residential, 6 DU per acre		
	R-8 - Residential, 8 DU per acre		
	R-12 - Residential, 12 DU per acre		
	R-18 - Residential, 18 DU per acre		
(cont)			

The information included on this map has been compiled by King County staff from a variety of sources and is subject to change without notice. King County makes no representations or warranties, express or implied, as to accuracy, completeness, timeliness, or rights to the use of such information. King County shall not be liable for any general, special, indirect, incidental, or consequential damages including, but not limited to, lost revenues or lost profits resulting from the use or misuse of the information contained on this map. Any sale of this map or information on this map is prohibited except by written permission of King County.

[King County](#) | [GIS Center](#) | [News](#) | [Services](#) | [Comments](#) | [Search](#)

By visiting this and other King County web pages, you expressly agree to be bound by terms and conditions of the site. [The details.](#)